

Licensing Sub-Committee

- Section 1 - Licensing Officers Report
- Appendix 1 - Copy of the Application
- Appendix 2 - Map of local area
- Appendix 3 - Representations
- Appendix 4 - Representations from Responsible Authorities

Licensing Sub-Committee

Section 1 - Licensing Officers Report



LICENSING SUB-COMMITTEE

REPORT

27 January 2012

Subject Heading:

Premises licence variation

Report Author and contact details:

David Lloyd Leisure, Squirrels Heath Lane
Gidea Park, RM2 6DP
Paul Campbell – Licensing Officer
01708 432777
licensing@havering.gov.uk

This application for a variation to a premises licence is made by David Lloyd Leisure Limited under section 34 of the Licensing Act 2003. The application was received by Havering’s Licensing Authority on 13th December 2012.

Geographical description of the area and description of the building

The premises are a large detached leisure and fitness centre also providing food and beverages.

The premises is a detached building situated on the north side of Squirrels Heath Lane it has residential properties to the east and west, the main entrance to the building is about 125 metres from Squirrels Heath Lane. The majority of premises in the local area are residential.

Public transport links to the venue are limited, the premises has its own car parking facilities.

A map of the area is attached to assist the committee.

Details of the application

The current premises licence permits (full copy attached)

Films, Recorded Music for the Bar, Restaurant, Function Rooms, Meeting Rooms and Gym		
Day	Start	Finish
Monday to Sunday	06:30hrs	22:30hrs

Indoor Sporting Events		
Day	Start	Finish
Monday to Sunday	09:00hrs	22:30hrs

Recorded Music for the Outdoor Pool Area and Outdoor Bar		
Day	Start	Finish
Monday to Sunday	10:00hrs	22:00hrs

Supply of Alcohol Provision of Facilities for Dance and Similar Entertainment		
Day	Start	Finish
Monday to Sunday	10:00hrs	22:30hrs

Live music		
Day	Start	Finish
Monday to Sunday	19:00hrs	22:30hrs

Variation applied for:

Films, Recorded Music (external areas are not varied by this application)		
Day	Start	Finish
Monday to Thursday	06:00hrs	23:00hrs
Friday & Saturday	06:00hrs	00:00hrs

Indoor Sporting Events		
Day	Start	Finish
Monday to Thursday	09:00hrs	23:00hrs
Friday & Saturday	09:00hrs	00:00hrs

Live Music		
Day	Start	Finish
Monday to Thursday	19:00hrs	23:00hrs
Friday & Saturday	19:00hrs	00:00hrs

Supply of Alcohol, Performance of Dance, Anything similar to live music recorded music and performance of dance, Provision of facilities for making music, provision of facilities for dancing, Provision of facilities of facilities similar to music and dance.		
Day	Start	Finish
Monday to Thursday	10:00hrs	23:00hrs
Friday & Saturday	10:00hrs	00:00hrs

Late Night Refreshment		
Day	Start	Finish
Friday & Saturday	23:00hrs	00:00hrs

To change the opening hours of the premises to Monday to Thursday 06:00hrs to 23:00hrs and Friday and Saturday 06:00hrs to 00:00hrs.

also

To delete the three paragraphs under "the protection of children from harm" and replace it with "Children under the age of 16 will not be permitted in the lounge after 21:00hrs unless they are dining or attending a pre-booked function and accompanied by an adult"

Seasonal variations & Non-standard timings

There is no variation to the seasonal variations or non-standard timings in this application.

Comments and observations on the application

The applicant acted in accordance with premises licence regulations 25 and 26 relating to the advertising of the application. The required newspaper advertisement was installed in the Romford Recorder on Friday 16th December 2011.

Summary

There were no valid representations against this application from interested parties.

There was one representation against this application from responsible authorities (Metropolitan Police)

Details of representations

Valid representations may only address the following licensing objectives:

The prevention of crime and disorder
The prevention of public nuisance
The protection of children from harm
Public safety

Responsible Authorities' representations

The Metropolitan Police have made a number of suggestions they wish the Licensing Sub-Committee to consider.

There were no representations from the following responsible authorities:

Public Health
The London Fire and Emergency Planning Authority
The Health & Safety Enforcing Authority
The Trading Standards Service
Planning Control & Enforcement
Children & Families Service

LONDON BOROUGH OF HAVERING



Havering
LONDON BOROUGH

Premises licence number

002182

Part 1 - Premises details

Postal address of premises, or if none, ordnance survey map reference or description

David Lloyd Leisure – Gidea Park, Romford
Helen Road Sports Ground, Squirrels Heath Lane, Gidea Park, Romford, RM2 6DP
01708 463 250

Where the licence is time limited the dates

Not applicable

Licensable activities authorised by the licence

Supply of alcohol, indoor sporting events, live music, recorded music, provision of entertainment facilities for dancing, provision of facilities for anything of a similar description to making music or dancing

The times the licence authorises the carrying out of licensable activities

Films

Recorded Music – Bar, Restaurant, Function Rooms, Meeting Rooms and Gym

Monday to Sunday - 06.30 to 22.30

Indoor Sporting Events

Monday to Sunday - 09.00 to 22.30

Recorded Music – Outdoor Pool Area and Outdoor Bar

Monday to Sunday - 10.00 to 22.00

Provision of facilities for Dance, Provision of facilities for Similar Entertainment
Supply of Alcohol

Monday to Sunday - 10.00 to 22.30

Live Music

Monday to Sunday 19.00 to 22.30

1 of 4

Signed
Steve Bromley, Licensing Officer



The opening hours of the premises

Monday to Sunday - 06.30 to 22.30

Where the licence authorises supplies of alcohol whether these are on and/ or off supplies

On and Off Supplies

Part 2

Name, (registered) address, telephone number and email (where relevant) of holder of premises licence

**David Lloyd Leisure Limited, The Hanger, Mosquito Way
Hatfield Business Park, Hatfield, Herts, AL10 9AX**

Registered number of holder, for example company number, charity number (where applicable)

1516226

Name, address and telephone number of designated premises supervisor where the premises licence authorises for the supply of alcohol

**Mr Calum Norman MacKay
15 Mahonia Drive, Langdon Hills, Basildon, Essex, SS16 6SD**

Personal licence number and issuing authority of personal licence held by designated premises supervisor where the premises licence authorises for the supply of alcohol

Basildon District Council – BAS/PM0943

Mandatory Conditions

(1) No supply of alcohol may be made under the premises licence –

- a. at a time when there is no designated premises supervisor in respect of the premises licence, or**
- b. at a time when the designated premises supervisor does not hold a personal licence or their personal licence is suspended.**

(2) Every supply of alcohol under the premises licence must be made or authorised by a person who holds a personal licence.

Annex 2 – Conditions Consistent with the Operating Schedule

The prevention of crime and disorder

The CCTV system shall be in operation at the premises at all times when the premises are used for licensable activities. Recorded tapes shall be kept for 28 days and be available for inspection by police and Council officers at all reasonable times.

Staff shall undertake regular patrols during the day and night to check the security of the internal and external of the premises.

Members shall only be allowed admittance by scanning their membership cards and guests shall only be permitted entrance by being signed in and paid for by a staff member at reception.

Members shall carry their key cards with them at all times whilst on the premises.

Public safety

Health and Safety and Fire Safety Risk Assessments shall be undertaken on a regular basis.

Staff shall be trained in Health and Safety and Fire Risk issues on a regular basis.

Notices shall be placed within the premises showing Fire Precaution and Fire Evacuation procedures.

Fire Evacuation Signage and fire fighting equipment shall be provided throughout the premises and shall be regularly checked.

The prevention of public nuisance

Music shall not be audible outside the premises after 22.00 hrs each evening.

The protection of children from harm

Children shall only be present at the Club up to 21.00 hrs where a table meal is consumed in the licensed area(s). If a table meal is ordered before 21.00 hrs, but the meal has not been consumed or is still awaited the child may remain in the licensed area(s) up to 21.30 hrs.

Children may go into the licensed area(s) when passing those areas to get to another unlicensed area, or when meals and non-alcoholic beverages are available for consumption in the licensed area(s)

After 21.00 hrs or 21.30 hrs, children on the premises shall be supervised in a crèche or child friendly play area that is not within or is separate from the licensed area(s).

3 of 4

Signed
Steve Bromley, Licensing Officer



Annex 3 – Conditions Attached after a Hearing by the Licensing Authority

Conditions

In addition to the use of Temporary Event Notices allowed under the Licensing Act 2003, the premises may open on 12 non-standard occasions, in line with the Association of Chief Police Officers guidelines; subject to a minimum of 10 working days' notice being given to the licensing authority and the Police for each occasion. The prior written consent of the Police shall be obtained and the police shall have absolute right to refuse any occasion.

A register shall be kept at the premises in the manner required by the Police and the Licensing Authority and available for inspection by the police or an Authorised Officer of the Licensing Authority and details of each occasion shall be recorded in it including the written consent of the police.

In addition:

1. No supply of alcohol to take place until the Licensing Service and police have seen evidence of the personal licence details of the DPS.
2. Concerning the protection of children from harm: That where a cinema film or other programme includes a film recommended by the Licensing Authority as falling into the 12A, 15 or 18 category, no person appearing to be under the age of 12 or unaccompanied, or under 15 or 18 as appropriate, shall be admitted to any part of the programme; and the Licence Holder shall display in a conspicuous position, a notice confirming the age requirement.

Annex 4 - Plans

Full Premises plans held by Licensing Authority of the London Borough of Havering

NOT TO SCALE

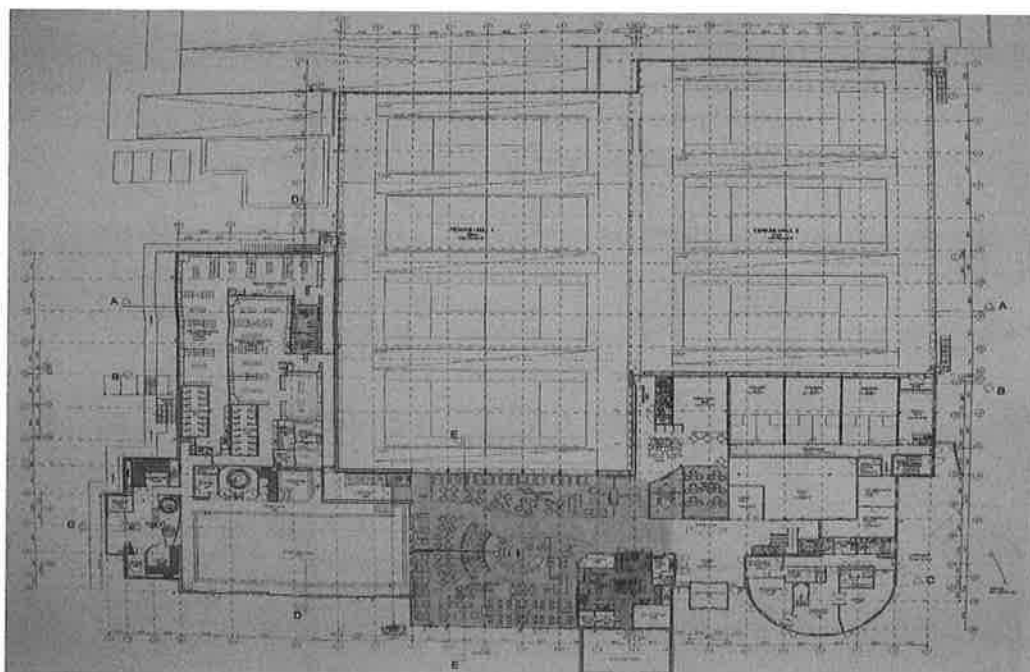

LONDON BOROUGH OF HAVERING



Havering
LONDON BOROUGH

**Part B
Premises licence summary**

Premises licence number

002182

Premises details

Postal address of club, if any, or if none, ordnance survey map reference or description

**David Lloyd Leisure – Gidea Park, Romford
Helen Road Sports Ground, Squirrels Heath Lane, Gidea Park, Romford, RM2 6DP
01708 463 250**

Where the licence is time limited the dates

Not applicable

Licensable activities authorised by the licence

Supply of alcohol, indoor sporting events, live music, recorded music, provision of entertainment facilities for dancing, provision of facilities for anything of a similar description to making music or dancing

The times the licence authorises the carrying out of licensable activities

Films

Recorded Music – Bar, Restaurant, Function Rooms, Meeting Rooms and Gym

Monday to Sunday - 06.30 to 22.30

Indoor Sporting Events

Monday to Sunday - 09.00 to 22.30

Recorded Music – Outdoor Pool Area and Outdoor Bar

Monday to Sunday - 10.00 to 22.00

**Provision of facilities for Dance, Provision of facilities for Similar Entertainment
Supply of Alcohol**

Monday to Sunday - 10.00 to 22.30

Live Music

Monday to Sunday 19.00 to 22.30

1 of 2

Signed
Steve Bromley, Licensing Officer



The opening hours of the premises

Monday to Sunday - 06.30 to 22.30

Where the licence authorises supplies of alcohol whether these are on and/ or off supplies

On and Off Supplies

Name, (registered) address, telephone number and email (where relevant) of holder of premises licence

**David Lloyd Leisure Limited, The Hanger, Mosquito Way
Hatfield Business Park, Hatfield, Herts, AL10 9AX**

Registered number of holder, for example company number, charity number (where applicable)

1516226

Name of designated premises supervisor where the premises licence authorises for the supply of alcohol

Mr Calum Norman MacKay

State whether access to the premises by children is restricted or prohibited

Restricted

2 of 2

Licensing Sub-Committee

Appendix 1 - Copy of the Application

Application to vary a premises licence under the Licensing Act 2003

PLEASE READ THE FOLLOWING INSTRUCTIONS FIRST

Before completing this form please read the guidance notes at the end of the form.
If you are completing this form by hand please write legibly in block capitals. In all cases ensure that your answers are inside the boxes and written in black ink. Use additional sheets if necessary.
You may wish to keep a copy of the completed form for your records.

We, David Lloyd Leisure Ltd, being the premises licence holder, apply to vary a premises licence under section 34 of the Licensing Act 2003 for the premises described in Part 1 below.

Premises Licence Number

002182

Part 1 - Premises details

Postal address of premises or, if none, ordnance survey map reference or description David Lloyd Leisure, Helen Road Sports Ground, Squirrels Heath Lane, Gidea Park	
Post town Romford	Post code RM2 6DP

Telephone number of premises (if any)

01708 463250

Non-domestic rateable value of premises

£630,000

Part 2 - Applicant Details

Daytime contact telephone number

01708 463250

Email address
(optional)

Current postal
address if
different from
premises address

The Hangar, Mosquito Way, Hatfield Business Park,

Post Town

Hatfield

Postcode

AL10 9AX

Part 3 – Variation

Do you want the proposed variation to have effect as soon as possible?

Please tick ✓/yes

If not do you want the variation to take effect from

Day Month Year

--	--	--	--	--	--	--	--	--	--

If your proposed variation would mean that 5,000 or more people are expected to attend the premises at any one time, please state the number expected to attend.

N/A

Please describe briefly the nature of the proposed variation (please read guidance note 1)

The premises operate as a David Lloyd Leisure Centre, providing leisure facilities and the usual food and beverage provision and occasional entertainment associated with the Clubs activities.

It is proposed to modernise the hours of operation to be in line with the requirements of clientele and to update the conditions in relation to children. The new terminal hour Sunday – Thursday : 23.00 and Friday – Saturday : 00.00 is in line with the recent variation to the Planning Permission.

The current licence permits sale by retail of alcohol Monday – Sunday 10:00hrs and 22:30hrs.

The variation seeks to adjust the licence as follows: -

1. Variation to extend the hours for sale by retail of alcohol and regulated entertainment Sunday – Thursday to 23.00 and Friday – Saturday to 00.00 (midnight).
2. To adjust the opening hours and pre-extend the licensable activity of recorded music and films Monday – Friday to 06.00.
3. To permit late night refreshment for the hours for sale by retail of alcohol.
4. To delete the three paragraphs under “the protection of children from harm” and replace with the following :-

“Children under the age of 16 will not be permitted in the lounge after 21.00 hrs unless they are dining or attending a pre-booked function and accompanied by an adult”.

It is not considered that the modest extension to licensable activities should be controversial or will adversely affect the licensing objectives. The operating statement has been completed on that basis.

No change is proposed to the layout at these premises.

Part 4 Operating Schedule

Please complete those parts of the Operating Schedule below which would be subject to change if this application to vary is successful.

Please tick ✓ yes

Provision of regulated entertainment

- | | |
|---|-------------------------------------|
| a) Plays (if ticking yes, fill in box A) | <input type="checkbox"/> |
| b) Films (if ticking yes, fill in box B) | <input checked="" type="checkbox"/> |
| c) indoor sporting events (if ticking yes, fill in box C) | <input checked="" type="checkbox"/> |
| d) boxing or wrestling entertainment (if ticking yes, fill in box D) | <input type="checkbox"/> |
| e) live music (if ticking yes, fill in box E) | <input checked="" type="checkbox"/> |
| f) recorded music (if ticking yes, fill in box F) | <input checked="" type="checkbox"/> |
| g) performances of dance (if ticking yes, fill in box G) | <input checked="" type="checkbox"/> |
| h) anything of a similar description to that falling within (e), (f) or (g) (if ticking yes, fill in box H) | <input checked="" type="checkbox"/> |

Provision of entertainment facilities for:

- | | |
|---|-------------------------------------|
| l) making music (if ticking yes, fill in box I) | <input checked="" type="checkbox"/> |
| j) dancing (if ticking yes, fill in box J) | <input checked="" type="checkbox"/> |
| k) entertainment of a similar description to that falling within (i) or (j) (if ticking yes, fill in box K) | <input checked="" type="checkbox"/> |

Provision of late night refreshment (if ticking yes, fill in box L)

Sale by retail of alcohol (if ticking yes, fill in box M)

In all cases complete boxes N, O and P

A

Plays Standard days and timings (please read guidance note 6)			Will the performance of a play take place indoors or outdoors or both – please tick {Y}. (please read guidance note 2).	Indoors	
Day	Start	Finish		Outdoors	
Mon			Please give further details here (please read guidance note 3)	Both	
Tue					
Wed					
Thur			State any seasonal variations for performing plays (please read guidance note 4)		
Fri					
Sat					
Sun			Non standard timings. Where you intend to use the premises for the performance of plays at different times to those listed in the column on the left, please list (please read guidance note 5)		

B

Films Standard days and timings (please read guidance note 6)			Will the exhibition of films take place indoors or outdoors or both – please tick {Y}. (please read guidance note 2).	Indoors	✓
Day	Start	Finish		Outdoors	
Mon	06:00	23:00	Please give further details here (please read guidance note 3) As per the existing Premises Licence	Both	
Tue	06:00	23:00			
Wed	06:00	23:00			
Thur	06:00	23:00	State any seasonal variations for the exhibition of films (please read guidance note 4)		
Fri	06:00	00:00			
Sat	06:30	00:00			
Sun	06:30	23:00	Non standard timings. Where you intend to use the premises for the exhibition of films at different times to those listed in the column on the left, please list (please read guidance note 5) When hours for sale of alcohol are extended hereunder these hours are also extended (see Box M below).		

C

Indoor sporting events Standard days and timings (please read guidance note 6)			Please give further details (please read guidance note 3)
Day	Start	Finish	<p>As per the existing premises Licence</p> <hr/> <p>State any seasonal variations for indoor sporting events (please read guidance note 4)</p> <hr/> <p>Non standard timings. Where you intend to use the premises for indoor sporting events at different times to those listed in the column on the left, please list (please read guidance note 5)</p> <p>When hours for sale of alcohol are extended hereunder these hours are also extended (see Box M below).</p>
Mon	09:00	23:00	
Tue	09:00	23:00	
Wed	09:00	23:00	
Thur	09:00	23:00	
Fri	09:00	00:00	
Sat	09:00	00:00	
Sun	09:00	23:00	

D

Boxing or wrestling entertainment Standard days and timings (please read guidance note 6)			Will the boxing or wrestling entertainment take place indoors or outdoors or both – please tick {Y} (please read guidance note 2).	
Day	Start	Finish	Indoors	
Mon			Outdoors	
Tue			Both	
Wed				
Thur				
Fri				
Sat				
Sun				

Boxing or wrestling entertainment Standard days and timings (please read guidance note 6)			Please give further details here (please read guidance note 3)
Day	Start	Finish	<p>State any seasonal variations for boxing or wrestling entertainment (please read guidance note 4)</p> <hr/> <p>Non standard timings. Where you intend to use the premises for boxing or wrestling entertainment at different times to those listed in the column on the left, please list (please read guidance note 5)</p>
Mon			
Tue			
Wed			
Thur			
Fri			
Sat			
Sun			

E

Live music Standard days and timings (please read guidance note 6)			Will the performance of live music take place indoors or outdoors or both – please tick {Y} (please read guidance note 2).	Indoors	✓
Day	Start	Finish		Outdoors	
Mon	19:00	23:00	Please give further details here (please read guidance note 3) As per the existing premises licence	Both	
Tue	19:00	23:00			
Wed	19:00	23:00	State any seasonal variations for the performance of live music (please read guidance note 4)		
Thur	19:00	23:00			
Fri	19:00	00:00	Non standard timings. Where you intend to use the premises for the performance of live music at different times to those listed in the column on the left, please list (please read guidance note 5) When hours for sale of alcohol are extended hereunder these hours are also extended (see Box M below).		
Sat	19:00	00:00			
Sun	19:00	23:00			

F

Recorded music Standard days and timings (please read guidance note 6)			Will the playing of recorded music take place indoors or outdoors or both – please tick {Y} (please read guidance note 2).	Indoors	
Day	Start	Finish		Outdoors	
Mon	06:00	23:00	Please give further details here (please read guidance note 3) As per the existing premises licence (recorded music in respect of the external areas is unadjusted by this application and will operate Monday – Sunday : 10.00 – 22.00)	Both	✓
Tue	06:00	23:00			
Wed	06:00	23:00	State any seasonal variations for playing recorded music (please read guidance note 4)		
Thur	06:00	23:00			
Fri	06:00	00:00	Non standard timings. Where you intend to use the premises for the playing of recorded music entertainment at different times to those listed in the column on the left, please list (please read guidance note 5) When hours for sale of alcohol are extended hereunder these hours are also extended (see Box M below).		
Sat	06:30	00:00			
Sun	06:30	23:00			

G

Performances of dance Standard days and timings (please read guidance note 6)			Will the performance of dance take place indoors or outdoors or both – please tick {Y} (please read guidance note 2).	Indoors	✓
Day	Start	Finish		Outdoors	
Mon	10:00	23:00	Please give further details here (please read guidance note 3) As per the existing premises licence	Both	
Tue	10:00	23:00			
Wed	10:00	23:00	State any seasonal variations for the performance of dance (please read guidance note 4)		
Thur	10:00	23:00			
Fri	10:00	00:00	Non standard timings. Where you intend to use the premises for the performance of dance entertainment at different times to those listed in the column on the left, please list (please read guidance note 5) When hours for sale of alcohol are extended hereunder these hours are also extended (see Box M below).		
Sat	10:00	00:00			
Sun	10:00	23:00			

H

Anything of a similar description to that falling within (e), (f) or (g) Standard days and timings (please read guidance note 6)			Please give a description of the type of entertainment you will be providing		
Day	Start	Finish	Will this entertainment take place indoors or outdoors or both – please tick {Y} (please read guidance note 2).	Indoors	✓
Mon	10:00	23:00		Please give further details here (please read guidance note 3) As per the existing premises licence	Outdoors
Tue	10:00	23:00			
Wed	10:00	23:00	State any seasonal variations for entertainment of a similar description to that falling within (e), (f) or (g) (please read guidance note 4)	Both	
Thur	10:00	23:00			
Fri	10:00	00:00	Non standard timings. Where you intend to use the premises for the entertainment of similar description to that falling within (e), (f) or (g) at different times to those listed in the column on the left, please list (please read guidance note 5) When hours for sale of alcohol are extended hereunder these hours are also extended (see Box M below).		
Sat	10:00	00:00			
Sun	10:00	23:00			

I

Provision of facilities for making music. Standard days and timings (please read guidance note 6)			Please give a description of the facilities for making music you will be providing										
			<table border="1"> <tr> <td>Will the facilities for making music be indoors or outdoors or both - please tick {Y} (please read guidance note 2).</td> <td>Indoors</td> <td>✓</td> </tr> <tr> <td></td> <td>Outdoors</td> <td></td> </tr> <tr> <td></td> <td>Both</td> <td></td> </tr> </table>		Will the facilities for making music be indoors or outdoors or both - please tick {Y} (please read guidance note 2).	Indoors	✓		Outdoors			Both	
Will the facilities for making music be indoors or outdoors or both - please tick {Y} (please read guidance note 2).	Indoors	✓											
	Outdoors												
	Both												
Day	Start	Finish											
Mon	10:00	23:00	Please give further details here (please read guidance note 3) As per the existing premises licence										
Tue	10:00	23:00											
Wed	10:00	23:00	State any seasonal variations for the provision of facilities for making music (please read guidance note 4)										
Thur	10:00	23:00											
Fri	10:00	00:00	Non standard timings. Where you intend to use the premises for provision of facilities for making music entertainment at different times to those listed in the column on the left, please list (please read guidance note 5) When hours for sale of alcohol are extended hereunder these hours are also extended (see Box M below).										
Sat	10:00	00:00											
Sun	10:00	23:00											

J

Provision of facilities for dancing Standard days and timings (please read guidance note 6)			Will the facilities for dancing be indoors or outdoors or both - please tick {Y} (see guidance note 2).							
			<table border="1"> <tr> <td>Indoors</td> <td>✓</td> </tr> <tr> <td>Outdoors</td> <td></td> </tr> <tr> <td>Both</td> <td></td> </tr> </table>		Indoors	✓	Outdoors		Both	
Indoors	✓									
Outdoors										
Both										
Day	Start	Finish								
Mon	10:00	23:00	Please give a description of the facilities for dancing you will be providing As per the existing premises licence							
Tue	10:00	23:00								
Wed	10:00	23:00	Please give further details here (please read guidance note 3)							
Thur	10:00	23:00								
Fri	10:00	00:00	State any seasonal variations for providing dancing facilities (please read guidance note 4) Non standard timings. Where you intend to use the premises for the provision of facilities for dancing entertainment at different times to those listed in the column on the left, please list (please read guidance note 5) When hours for sale of alcohol are extended hereunder these hours are also extended (see Box M below).							
Sat	10:00	00:00								
Sun	10:00	23:00								

K

Provision of facilities for entertainment of a similar description to that falling within I or J Standard days and timings (please read guidance note 6)			Please give a description of the type of entertainment facility you will be providing	
Day	Start	Finish	Will the entertainment facility be indoors or outdoors or both – please tick {Y} (please read guidance note 2).	Indoor <input checked="" type="checkbox"/>
				Outdoor
Mon	10:00	23:00		Both
Tue	10:00	23:00		Please give further details here (please read guidance note 3)
Wed	10:00	23:00	As per the existing premises licence	
Thur	10:00	23:00	State any seasonal variations for the provision of facilities for entertainment of a similar description to that falling within I or J (please read guidance note 4)	
Fri	10:00	00:00		
Sat	10:00	00:00	Non standard timings. Where you intend to use the premises for the provision of facilities for entertainment of a similar description to that falling within I or J at different times to those listed in the column on the left, please list (please read guidance note 5)	
Sun	10:00	23:00	When hours for sale of alcohol are extended hereunder these hours are also extended (see Box M below).	

L

Late night refreshment Standard days and timings (please read guidance note 6)			Will the provision of late night refreshment take place indoors or outdoors or both – please tick {Y} (please read guidance note 2).	
Day	Start	Finish	Indoors	<input checked="" type="checkbox"/>
			Outdoors	
			Both	
Mon			Please give further details here (please read guidance note 3)	
Tue			As per the existing premises licence	
Wed			State any seasonal variations for the provision of late night refreshment (please read guidance note 4)	
Thur				
Fri	23:00	00:00	Non standard timings. Where you intend to use the premises for the provision of late night refreshment at different times, to those listed in the column on the left, please list (please read guidance note 5)	
Sat	23:00	00:00		
Sun			When hours for sale of alcohol are extended hereunder these hours are also extended (see Box M below).	

M

Supply of alcohol Standard days and timings (please read guidance note 6)			Will the supply of alcohol be for consumption (Please tick box Y) (please read guidance note 7)	On the premises	
Day	Start	Finish		Off the premises	
Mon	10:00	23:00	State any seasonal variations for the supply of alcohol (please read guidance note 4)	Both	<input checked="" type="checkbox"/>
Tue	10:00	23:00			
Wed	10:00	23:00			
Thur	10:00	23:00		Non-standard timings. Where you intend to use the premises for the supply of alcohol at different times to those listed in the column on the left, please list (please read guidance note 5) Non-standard timings to continue as per the existing premises licence	
Fri	10:00	00:00			
Sat	10:00	00:00			
Sun	10:00	23:00			

N

Please highlight any adult entertainment or services, activities, other entertainment or matters ancillary to the use of the premises that may give rise to concern in respect of children (please read guidance note 8)

None

0

Hours premises are open to the public Standard days and timings (please read guidance note 6)			State any seasonal variation (please read guidance note 4)
Day	Start	Finish	
Mon	06:00	23:00	Non standard timings. Where you intend to use the premises to be open to the public at different times from those listed in the column on the left, please list (please read guidance note 5) Non-standard timings to remain as per the existing premises licence
Tue	06:00	23:00	
Wed	06:00	23:00	
Thur	06:00	23:00	
Fri	06:00	00:00	
Sat	06:30	00:00	
Sun	06:30	23:00	

Please identify those conditions currently imposed on the licence which you believe could be removed as a consequence of the proposed variation you are seeking

Conditions under "protection of children from harm" are to be deleted and replaced – see operating statement

Please tick ✓ yes

I have enclosed the premises licence

I have enclosed the relevant part of the premises licence

If you have not ticked one of these boxes please fill in reasons for not including the licence, or part of it, below

Reasons why I have failed to enclose the premises licence or relevant part of premises licence

P

Describe any additional steps you intend to take to promote the four licensing objectives as a result of the proposed variation:

a) General – all four licensing objectives (b,c,d,e) (please read guidance note 9)

I have undertaken my own risk assessment to take the following proposed steps.

No new steps have been identified in relation to the four licensing objectives save as below.

The premises presently operate without difficulty as a Leisure Club. The style of operation is unchanged and it is not anticipated that the extension of hours or change to conditions will adversely affect the four licensing objectives.

b) The prevention of crime and disorder

No further risks have been identified which need to be addressed.

c) Public safety

No further risks have been identified which need to be addressed.

d) The prevention of public nuisance

No further risks have been identified which need to be addressed.

e) The protection of children from harm

The restrictions set out in the Licensing Act 2003 will apply. No unusual or additional risks of harm to children have been identified.

The existing 3 conditions on the Licence are to be deleted and replaced with :-

“Children under the age of 16 will not be permitted in the lounge after 21.00 hrs unless they are dining or attending a pre-booked function and accompanied by an adult”.

- I have made or enclosed payment of the fee
- I have sent copies of this application and the plan to responsible authorities and others where applicable
 - I understand that I must now advertise my application
 - I have enclosed the premises licence or relevant part of it or explanation
 - I understand that if I do not comply with the above requirements my application will be rejected

IT IS AN OFFENCE, LIABLE ON CONVICTION TO A FINE UP TO LEVEL 5 ON THE STANDARD SCALE, UNDER SECTION 158 OF THE LICENSING ACT 2003 TO MAKE A FALSE STATEMENT IN OR IN CONNECTION WITH THIS APPLICATION

Part 5 – Signatures (please read guidance note 10)

Signature of applicant (the current premises licence holder) or applicant’s solicitor or other duly authorised agent. (Please read guidance note 11). **If signing on behalf of the applicant please state in what capacity.**

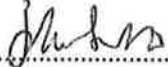
Signature: John Gaunt & Partners 

Date: 12 December, 2011

Capacity: Solicitors.....

Where the premises licence is jointly held signature of 2nd applicant (the current premises licence holder) or 2nd applicant’s solicitor or other authorised agent. (Please read guidance note 12). **If signing on behalf of the applicant please state in what capacity.**

Signature: John Gaunt & Partners

Date:

Capacity: Solicitors.....

Contact name (where not previously given) and address for correspondence associated with this application (please read guidance note 13)	
John Gaunt & Partners Omega Court 372 Cemetery Road	
Post town Sheffield	Post code S11 8FT
Telephone number (if any) 0114 266 8664	
If you would prefer us to correspond with you by email your email address (optional)	

Licensing Sub-Committee

Appendix 2 - Map of local area



David Lloyd

Map Reference: TQ5389NE



Scale @ A4 1:1250
Date: 10/01/2012

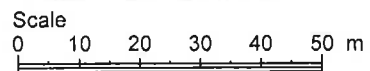

Havering
LONDON BOROUGH

London Borough of Havering
Town Hall, Main Road
Romford, RM1 3BD
Tel: 01708 434343

© Crown copyright and database rights 2012 Ordnance Survey 100024327

Licensing Sub-Committee

Appendix 3 - Representations



**METROPOLITAN
POLICE**

Working together for a safer London

**Licensing Authority
London Borough of Havering
Mercury House, Mercury Gardens,
Romford, Essex
RM1 3SL**

**PC David Fern
Police licensing officer
Romford Police Station
19 Main Road
Romford,
Essex
RM1 3BJ**

Telephone: 01708 432781
Fax: 01708 432554

Email:
David-anthony.fern@met.police.uk
Date: 31st December 2011

Dear Sir,

The Metropolitan Police would like to make representation against the application to vary the Premises Licence at David Lloyd Leisure, Gidea Park RM2.

After a recent visit to the premises to inspect the CCTV system, I feel that the system is adequate to the requirements of the premises. This was initially high lighted in an incident report submitted to Havering police. The report states that the CCTV was of a poor quality and unusable for the investigation.

The function area of the bar is not covered by CCTV. The camera in this area covers the serving section at the bar. The intention in this application is to be open later; this in turn with the licence allows the club to provide occasional entertainment. I understand this includes private parties, for both members and non members. This produces some risk to allowing licensable activity till mid night at the weekends.

The licence includes many aspects of entertainment and inline with this application the applicant intends to extend all of these hours.

There is no mention of proving SIA security at the premises during these events.

I am not able to support this application, based on the applicant not meeting the requirements under the Crime Prevention and Disorder objective to a satisfactory level.

I am in support of the proposed amendments to the protection of children from harm. I would also like to see a challenge 21 policy in the bar area introduced, given that both member and non members are able to use the facilities during these events held at the club.

I would ask the applicant to read the Havering licensing policy and the pool of conditions relating to CCTV. In particular conditions; CD17, CD18, CD19, and CD21. This is available online from the London borough of Havering website.

I would seek to impose some of these conditions on to the licence if the licensing committee were to agree to the variation of the licence against this representation.

If I can be of any further assistance in this matter please do not hesitate to contact me in the licensing office.

Yours sincerely

PC David Fern
Metropolitan police - Havering
Licensing officer